

## imageRUNNER C1530 Series

# FAST AND SECURE COLOUR A4 DEVICES FOR ALL YOUR PRINTING AND SCANNING NEEDS

### MAIN CONFIGURATION OPTIONS

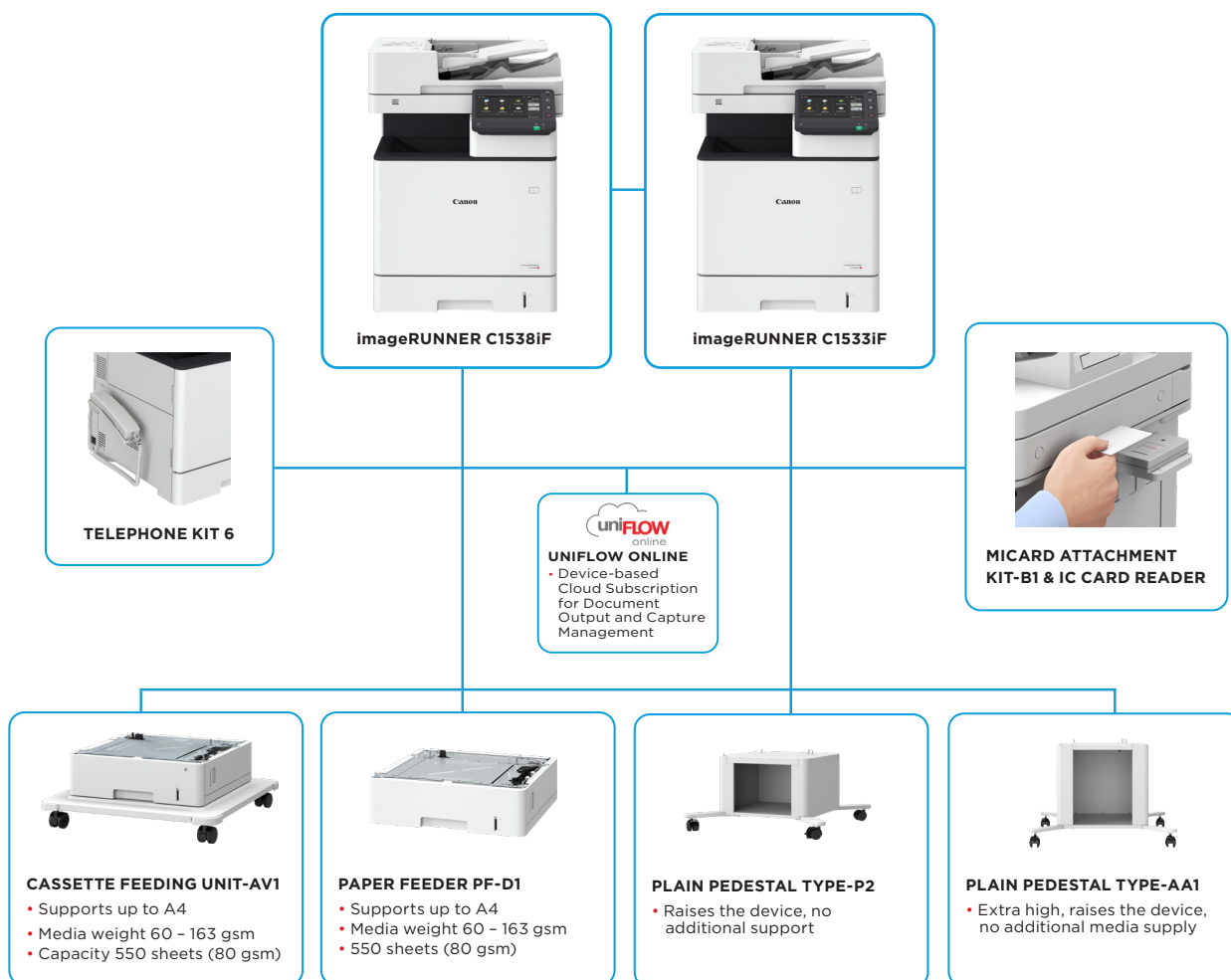

This flat configuration is for illustration purpose only. For a complete list of options and the exact compatibility relationships, please refer to the [online product configurator](#)

# TECHNICAL SPECIFICATIONS

# imageRUNNER C1530 Series

## MAIN UNIT

<b>Machine type</b>	A4 Colour Laser Multifunctional
<b>Core functions</b>	Print, Copy, Scan, Send and Fax
<b>Processor</b>	1GHz Dual Core Processor
<b>Control Panel</b>	17.8 cm/7 inch TFT LCD WVGA Colour Touch panel
<b>Memory</b>	Standard: 2.0GB RAM
<b>Storage</b>	Standard: 64GB eMMC (available space 30GB)
<b>Interface Connection</b>	NETWORK Standard: 1000Base-T/100Base-TX/10Base-T, Wireless LAN (IEEE 802.11 b/g/n) OTHERS Standard: USB 2.0 (Host) x2, USB 2.0 (Device) x1
<b>Paper Supply Capacity (A4, 80gsm)</b>	Standard: 650 sheets Maximum: 2300 sheets (with Cassette Feeding Unit-AV1 + Paper Feeder PF-D1 x 2)
<b>Paper output capacity (A4, 80gsm)</b>	Standard: 200 sheets Maximum: 200 sheets
<b>Finishing Capabilities</b>	Collate, Group
<b>Supported Media Types</b>	Multi-purpose Tray: Thin, Plain, Recycled, Colour, Heavy, Bond, Transparency, Label, Pre-punched, Envelope Paper Cassette: Plain, Recycled, Colour, Pre-punched
<b>Supported Media Sizes</b>	Multi-purpose tray: Standard size: A4R, A5, A5R, A6R, B5R, Envelopes [No. 10(COM 10), Monarch, ISO-C5, DL] Custom Size/Free Size: Min.76.2 x127.0 mm up to 216.0 x355.6 mm Paper Cassette: Standard size: A4R, A5, A5R, A6R, B5R
<b>Supported Media Weights</b>	Multi-purpose tray: 60 to 216 gsm Paper Cassettes: 60 to 163 gsm Duplex: 60 to 163 gsm
<b>Warm-up Time</b>	4 Seconds or Less* * Time from device power-on to when key operations can be performed on the touch panel display. From Sleep Mode: 10 seconds or less 12 Seconds or Less* *Time from device power on, until copy ready (not print reservation)
<b>Dimensions (W x D x H)</b>	500 x 556 x 640 mm
<b>Installation Space (W x D)</b>	717 x 785 mm (with Multipurpose Tray extended and Cassette door open)
<b>Weight</b>	Approx. 41.0 kg including toner

## PRINT SPECIFICATIONS

<b>Print Speed (BW/CL)</b>	iR C1538iF: Up to 38/38 ppm (A4R) Up to 40/40 ppm (A5R), Up to 59/59 ppm (A5) iR C1533iF: Up to 33/33 ppm (A4R) Up to 40/40 ppm (A5R), Up to 55/55 ppm (A5)
<b>Print Resolution (dpi)</b>	Up to 1,200 x 1,200
<b>Page description languages</b>	Standard: UFR II, PCL6, Adobe® PostScript®3™
<b>Direct Print</b>	Supported file types: RUI: PDF, EPS, TIFF/JPEG, XPS USB Memory: PDF, TIFF/JPEG, XPS Network Place: PDF, TIFF/JPEG, XPS AirPrint, Mopria, Universal Print by Microsoft
<b>Printing from mobile and cloud</b>	AirPrint, Mopria, Canon PRINT Business and uniFLOW Online A range of software solutions is available to provide printing from mobile devices and cloud-based services depending on your requirements. Please contact your sales representative for further information
<b>Fonts</b>	PS fonts: 136 Roman PCL fonts: 93 Roman, 10 Bitmap fonts, 2 OCR fonts, Andalé Mono WT J/K/S/T <sup>1</sup> (Japanese, Korean, Simplified and Traditional Chinese), Barcode fonts <sup>2</sup> <sup>1</sup> Requires optional PCL International Font Set-A1 <sup>2</sup> Requires optional Barcode Printing Kit-D1
<b>Print Features</b>	Secure Print, Watermark, Header/Footer, Page Layout, Two-sided Printing, Mixed Paper Sizes/ Orientations, Toner Reduction, Poster Printing, Forced Hold Printing, Print Date, Scheduled Printing, Printing Using a Virtual Printer

## Operating System

UFR II: Windows® 8.1/10/Server 2012/Server 2012 R2/Server 2016/Server 2019, MAC OS X (10.11 or later)  
PCL: Windows® 8.1/10/Server 2012/Server 2012 R2/Server 2016/Server 2019  
PS: Windows® 8.1/10/Server 2012/Server 2012 R2/Server 2016/Server 2019, MAC OS X (10.10 or later)  
PPD: Windows® 8.1/10, MAC OS X (10.10 or later)  
As of January, 2021

## COPY SPECIFICATIONS

<b>Copy Speed (BW/CL)</b>	iR C1538iF: Up to 38/38 ppm (A4R) Up to 40/40 ppm (A5R), Up to 59/59 ppm (A5) iR C1533iF: Up to 33/33 ppm (A4R) Up to 40/40 ppm (A5R), Up to 55/55 ppm (A5)
<b>First-Copy-Out Time (A4, BW/CL)</b>	Approx. 5.9/6.9 seconds or less
<b>Copy resolution (dpi)</b>	600 x 600
<b>Multiple Copies</b>	Up to 999 copies
<b>Copy Density</b>	Automatic or Manual (9 Levels)
<b>Magnification</b>	25% to 400% (1% Increments) Preset reduction/enlargement: 25%, 50%, 70%, 100%, 141%, 200%, 400%
<b>Copy Features</b>	Preset R/E Ratios by Area, Two-Sided, Density Adjustment, Original Type Selection, Interrupt Mode, Two-sided Original, Sort, Job Build, N on 1, Sharpness, Erase Frame, Copy ID Card, Skip Blank Pages, Colour Mode, Reserved copy, Copy Sample

## SCAN SPECIFICATIONS

<b>Type</b>	Standard: Single-pass Duplexing Automatic Document Feeder (2-sided to 2-sided)
<b>Document Feeder Paper Capacity (80 gsm)</b>	up to 100 sheets
<b>Acceptable Originals and weights</b>	Platen: Sheet, Book Document Feeder media weight : 1-sided scanning: 42 to 128 gsm (BW), 64 to 128 gsm (CL) 2-sided scanning: 50 to 128 gsm (BW), 64 to 128 gsm (CL)
<b>Supported media sizes</b>	Platen: max. scanning size: 216.0 x 355.6 mm Document Feeder media size: A4R, A5R, A6R, B5R Custom size: 48.0 x128.0 mm to 216.0 x 355.6 mm
<b>Scan Speed (ipm: BW/CL, A4)</b>	DADF: 1-sided Scanning: 95/95 (300 dpi, send), 50/50 (600 dpi, copy) 2-sided Scanning: 150/145 (300 dpi, send), 50/50 (600 dpi, copy)
<b>Scan Resolution (dpi)</b>	Scan for Copy: up to 600 x 600 Scan for Send: (Push,BW) up to 600 x 600, (Pull,BW) up to 600 x 600 (Push,CL) up to 300 x 300, (Pull,CL) up to 300 x 300 Scan for Fax: up to 600 x 600
<b>Pull Scan Specifications</b>	Colour Network ScanGear2. For both TWAIN and WIA Supported OS: Windows®7/8.1/10/Server2008/Server2008 R2/Server2012/Server2012 R2/Server 2016/Server 2019
<b>Scan Method</b>	PushScan, PullScan, Scan to Network, Scan to USB Memory Key, Scan to Mobile device, Scan to cloud (uniFLOW Online/Online Express)

# TECHNICAL SPECIFICATIONS

# imageRUNNER C1530 Series

## SEND SPECIFICATIONS

<b>Destination</b>	Standard: E-mail/Internet FAX (SMTP), Super G3 FAX, SMB3.0, FTP, WebDAV
<b>Address Book</b>	LDAP (2,000)/Local (1,600)/Speed dial (200)
<b>Send resolution (dpi)</b>	Push: 100 x 100, 150 x 150, 200 x 100 (Normal), 200 x 200 (Fine), 200 x 400* (SuperFine), 300 x 300, 400 x 400* (UltraFine), 600 x 600*  Pull: 75 x 75, 100 x 100, 150 x 150, 200 x 200, 300 x 300, 400 x 400*, 600 x 600* *Colour mode is black and white only
<b>Communication protocol</b>	File: FTP (TCP/IP), SMB3.0 (TCP/IP), WebDAV Email/iFax: SMTP (send), POP3 (receive)
<b>File Format</b>	Standard: TIFF (MMR), JPEG*, PDF (Compact, Searchable, PDF/A-1b, Encrypted), XPS (Compact, Searchable), PDF/XPS (Device Signature, Office Open XML (PowerPoint, Word)) Optional: PDF (Trace & Smooth), PDF/XPS (User Signature) *Single page only
<b>Universal Send Features</b>	Original Type Selection, Two-sided Original, Density Adjustment, Sharpness, Erase Frame, Job Build, Delayed Send, Preview, Job Done Notice, File Name, Subject/Message, Reply-to, E-mail Priority, TX Report, Original Content Orientation

## FAX SPECIFICATIONS

<b>Maximum Number of Connection Lines</b>	1
<b>Modem Speed</b>	Super G3: 33.6 kbps G3: 14.4 kbps
<b>Compression Method</b>	MH, MR, MMR, JBIG
<b>Resolution (dpi)</b>	400 x 400 (Ultrafine), 200 x 400 (Superfine), 200 x 200 (Fine), 200 x 100 (Normal)
<b>Sending/Recording Size</b>	Sending: A4, A5*1, A6*1, B5*1 Receiving: A4, A5, B5 *1 Sent as A4
<b>FAX memory</b>	Up to 30,000 pages
<b>Speed dials</b>	Max. 200
<b>Group dials/destinations</b>	Max. 199 dials
<b>Sequential broadcast</b>	Max. 256 addresses
<b>Memory backup</b>	Yes
<b>Fax Features</b>	Sender's Name (TTI), Direct Send, Delayed Send, Preview, Job Done Notice, TX Report, Interrupt Transmission, Sequential Broadcasting, Password/Subaddress Sending, Confidential Mailbox

## STORE SPECIFICATION

<b>Memory Media</b>	Standard: USB Memory
---------------------	----------------------

## SECURITY SPECIFICATIONS

<b>Authentication and Access Control</b>	User Authentication (Picture Login, Picture and PIN Login, Username and Password Login, Function Level Login, Mobile Login), Department ID Authentication (Department ID and PIN Login, Function Level Login), uniFLOW Online Express (PIN Login, Picture Login, Picture and PIN Login, Card Login, Card and PIN Login, Username and Password Login, Department ID and PIN Login, Function Level Login), Access Management System (Access Control)
--	--

<b>Document Security</b>	Print Security (Secure Print, Encrypted SecurePrint, Forced Hold Printing, uniFLOW Secure Print*1), Recieve Data Security (Confidential Fax Inbox Forwarding Received Documents Automatically), Scan Security (Encrypted PDF, Device Signature PDF/XPS, User Signature PDF/XPS*2), Send Data Security (Setting for requesting password input per transmission, Restricted E-mail/File send functions, Confirming FAX number, Allow/Restrict Fax Driver Transmissions, Allow/Restrict Sending from History, S/MIME Support),
--------------------------	---

\*1 Requires optional uniFLOW Online / uniFLOW  
\*2 Requires optional Universal Send Digital User Signature Kit-C1

## Network Security

TLS 1.3, IPsec, IEEE802.1X authentication, SNMP V3.0, Firewall Functionality (IP/MAC Address Filtering), Dual Network Support (Wired LAN/Wireless LAN, Wired LAN/Wired LAN), Disabling/Enabling (Network Protocols/Applications, Remote UI, USB Interface), G3 FAX separation from LAN, USB Port separation from LAN, Scan and Send -Virus Concerns for E-mail Reception

## Device Security

Standard Storage Initialize, Job Log Conceal Function, Protecting MFP Software Integrity, Verify System at Startup, Runtime Intrusion Detection

## Device Management and Auditing

Administrator Password, Digital Certificate and Key Management, Audit Log, Cooperating with External Security Audit System (Security Information and Event Management), Security Policy Setting

## ENVIRONMENTAL SPECIFICATIONS

### Operating Environment

Temperature: 10 to 30 °C  
Humidity: 20 to 80% RH (Relative Humidity)

### Power source

iR C1538iF: 220-240V 50/60Hz 4.0A  
iR C1533iF: 220-240V 50/60Hz 3.9A

### Power consumption

Maximum: Approx. 1,500 W  
Standby: Approx. 33.3 W\*1  
Sleep mode: Approx. 1.1 W\*2

\*1 Reference value: measured one unit

\*2 Sleep mode is not available in all circumstances due to certain settings.

Typical Electricity Consumption (TEC)\* :

iR C1538iF : 0.43 kWh

iR C1533iF : 0.40 kWh

\*As per US ENERGY STAR version 3.0

Sound Power Level (LWA,m)

Active (1-sided): 6.1B\*1, Kv 0.3B\*1

\*1 Reference value: measured only one unit with ISO7779, described with ISO9296:2017

Sound Pressure Level (LpAm)

Bystander's position:

Active (1-sided): 50 dB\*1

\*1 Reference value: measured only one unit with ISO7779, described with ISO9296:2017

### Noise levels (BW/CL)

## Standards

Blue Angel (applied for)

## CONSUMABLES

### Toner Cartridge/s

T10 TONER BK/C/M/Y  
T10L TONER BK/C/M/Y

### Toner Yield (Estimated @ 5% Coverage)

T10 TONER BK: 13,000 pages  
T10 TONER C/M/Y: 10,000 pages  
T10L TONER BK: 6,000 pages  
T10L TONER C/M/Y: 5,000 pages

## SOFTWARE AND PRINTER MANAGEMENT

### Tracking and reporting

uniFLOW Online Express

### Remote management tools

iW Enterprise Management Console  
eMaintenance  
Content Delivery System

### Scanning software

Network ScanGear

# TECHNICAL SPECIFICATIONS

# imageRUNNER C1530 Series

## PAPER SUPPLY OPTIONS

### CASSETTE FEEDING UNIT-AV1

Paper Capacity: 550 sheets (80 gsm)  
Paper Type: Thin, Plain, Heavy, Recycled, Colour, Pre-punched, Bond, Labels  
Paper Size: A4R, A5, A5R, A6R, B5R  
Custom Size: 101.6 × 148.0 mm to 216.0 × 355.6 mm  
Paper Weight: 60 to 163 gsm  
Dimensions (W x D x H): 597 x 635 x 225 mm  
Weight: Approx. 15.5 kg

### Paper Feeder PF-D1

Paper Capacity: 550 sheets (80 gsm)  
Paper Type: Thin, Plain, Heavy, Recycled, Colour, Pre-punched, Bond, Labels  
Paper Size: A4R, A5, A5R, A6R, B5R  
Custom Size: 101.6 × 148.0 mm to 216.0 × 355.6 mm  
Paper Weight: 60 to 163 gsm  
Dimensions (W x D x H): 458 x 464 x 130 mm  
Weight: Approx. 6.1 kg

## HARDWARE ACCESSORIES

### CARD READERS

Copy Card Reader Attachment-J1  
Copy Card Reader-F1

### OTHERS

MiCARD Attachment Kit-B1

## SYSTEM AND CONTROLLER OPTIONS

### PRINT ACCESSORIES

PCL International Font Set-A1.

### SEND OPTIONS

Universal Send Trace & Smooth PDF Kit-A1  
Universal Send Digital User Signature Kit-C1

### Barcode Printing

Barcode Printing Kit-D1

### System Accessories

Copy Control Interface Kit-C1

## OTHER OPTIONS

### ACCESSIBILITY ACCESSORIES

ADF Access Handle-A1  
TELEPHONE 6 KIT Long cord Cool White

## Software & Solutions



## Compatibility



Canon Inc.  
canon.com

Canon Europe  
canon-europe.com

English edition

© Canon Europa N.V., 2021